

Orona 3G 2025

Machine-room above electrical gearless solutions

With the latest direct drive technology in public buildings.
Less noise and more accessible maintenance.
The customised solution with a machine room and the latest technology.

General specifications

Load	320 to 1,000 kg
Capacity	4 to 13 persons
Speed	1 - 1.6 m/s
Maximum travel	60 m
Maximum floors served	16 - 21 floors
Entrances	1 front / 2 open through
Drive system	Regulated gearless
Controller	ARCA III controller, low energy consumption multiprocessor
Door types	Automatic side-opening / Automatic central-opening
Clear door opening	From 800 to 1,500 mm (in 100 mm increments)
Door height	2,000 / 2,100 / 2,200 / 2,300 mm
Car dimensions	Parametric car dimensions
Internal car height	2,100 / 2,200 / 2,300 / 2,400 mm
Aesthetic solutions	Public Packs Reference / Public Packs Selection / Orona 3G Public Plus

Standard Optional

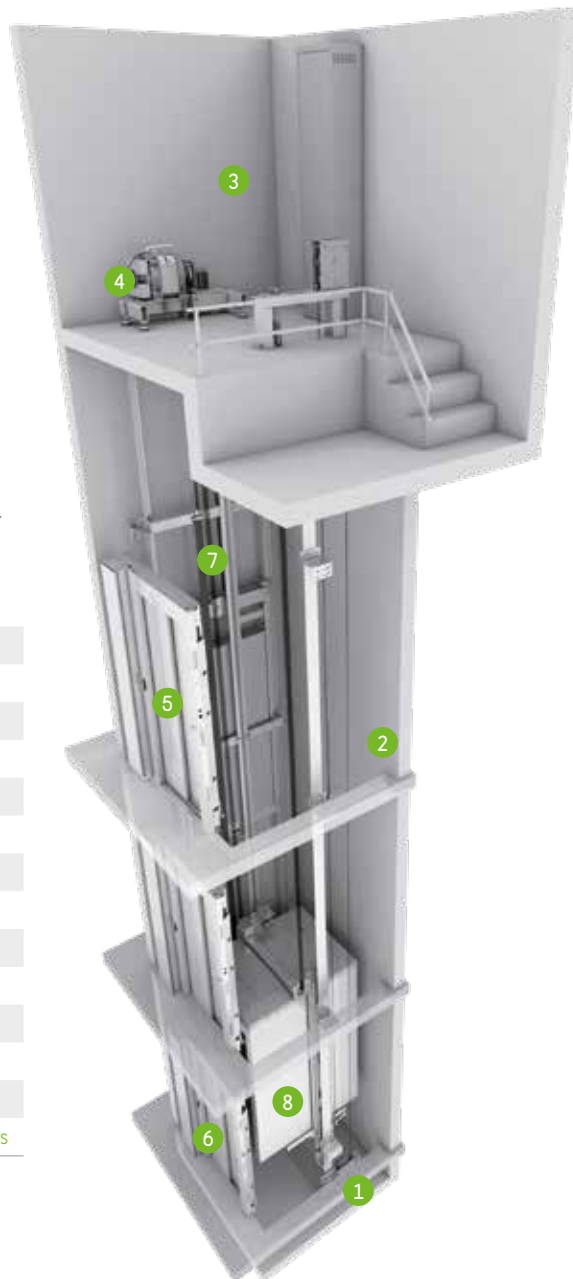

1 ACCESSIBLE SPACE BELOW THE PIT

Adapts the lift to suit buildings which have an accessible space below the pit (optional).



2 PARAMETRIC/FLEXIBLE

Flexible car and door configurations ensure available shaft dimensions to meet the requirements of the lift well (optional).



3 MACHINE-ROOM

A traditional solution simplifying lift maintenance.



4 DRIVE

Compact, quiet, gearless, energy efficient, speed regulated (VVVF) permanent magnet electric motor.



5 SOLID DOORS

Extra robust doors with reduced sound levels inside and outside the lift and which are specially constructed for high volume passenger traffic.



6 AUTOMATIC RESCUE SYSTEM

With floor level indication to ensure fast, efficient and safe evacuation of passengers in the event of an emergency. As an option, the system can incorporate a fully-automatic rescue device to evacuate passengers in the event of a power failure.



7 TRACTION ROPES

Orona small diameter ropes replace traditional steel ropes. As a result of their lighter weight, longer lifespan and greater flexibility, it is possible to use a more compact, efficient and eco-friendly gearless machine.



8 TWO-WAY COMMUNICATIONS

Between the lift and the emergency 24-hour Service Call Centre according to EN 81-28.



ECO-EFFICIENCY



ADAPTABILITY



DESIGN AND ACCESSIBILITY



CONTROL AND SAFETY

Standard dimensions*

Load / capacity			Car			Lift shaft ⁰								
Speed	Persons	Q Load	AC Width	FC Depth	PL Clear opening	Entrances		Side-opening doors		Central-opening doors		HF Pit	HUP ⁴ Headroom	
						Accessibility	No. of entrances	AH Width	FH ¹ Depth	AH Width	FH ² Depth			
1 m/s	6	450 kg	1,000	1,250	800	♿	1	1,470	1,520	1,720	1,470	1,000 (850) ³	3,400	
							2x180 ⁰		1,690		1,590			
	8	630 kg	1,100	1,400	900	♿	1	1,570	1,670	1,900	1,620			
							2x180 ⁰		1,840		1,740			
	10	800 kg	1,350	1,400	900	♿	1	1,820	1,670	1,900	1,620			
							2x180 ⁰		1,840		1,740			
	13	1000 kg	1,000	1,600	1,400	1,000	♿	1	2,070	1,670	2,100			1,620
								2x180 ⁰		1,840				1,740
				1,400	1,600	1,000	♿	1	1,870	1,870	2,100			1,820
								2x180 ⁰		2,040				1,940
				1,100	2,100	1,000	♿	1	1,720	2,370	2,100			2,320
								2x180 ⁰		2,540				2,440
1,6 m/s	6	450 kg	1,000	1,250	800	♿	1	1,470	1,520	1,720	1,470	1,120	3,550	
							2x180 ⁰		1,690		1,590			
	8	630 kg	1,100	1,400	900	♿	1	1,570	1,670	1,900	1,620			
							2x180 ⁰		1,840		1,740			
	10	800 kg	1,350	1,400	900	♿	1	1,820	1,670	1,900	1,620			
							2x180 ⁰		1,840		1,740			
	13	1,000 kg	1,000	1,600	1,400	1,000	♿	1	2,070	1,670	2,100			1,620
								2x180 ⁰		1,840				1,740
				1,400	1,600	1,000	♿	1	1,870	1,870	2,100			1,820
								2x180 ⁰		2,040				1,940
				1,100	2,100	1,000	♿	1	1,720	2,370	2,100			2,320
								2x180 ⁰		2,540				2,440

0 Minimum plumb measurements

- 1 Shaft depth with doors tracks projecting 60 mm on the landing (doors adapted 50 mm towards the lift shaft) (std. doors 90 mm sill)
- 2 Shaft depth with doors tracks projecting 40 mm on the landing (doors adapted 34 mm towards the lift shaft) (std. doors 54 mm sill)

3 HF reduced pit optional 850 mm

4 HUP minimum for internal car height (HC) 2,100 mm (HUP=HC+1,300)

Note: minimum AH dimensions calculated with the most favourable combination of controller cabinet and door pillar it is connected to

* The information is not contractually binding and is subject to the conditions of the shaft

Layout*

1 ENTRANCE

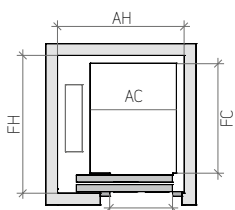

2 ENTRANCES (OPEN THROUGH)

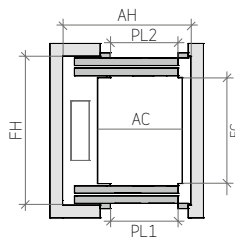

VERTICAL SECTION

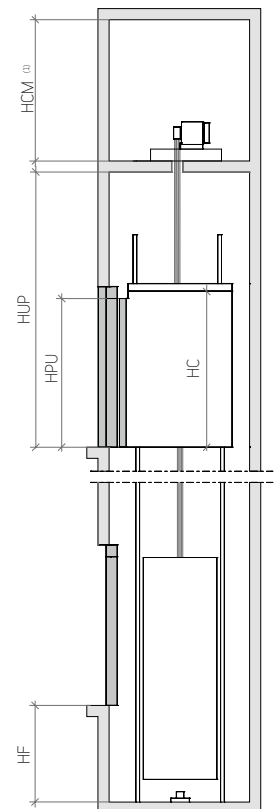

* Note: The diagrams are for guidance only

Customised car dimensions

Car width												
										13	12	1,600
										13	11	1,500
										13	10	1,400
										13	9	1,300
										13	8	1,200
										13	8	1,100
										12	8	1,000
										11	8	900
2,100	2,000	1,900	1,800	1,700	1,600	1,500	1,400	1,300	1,200			800
												900
												1,000
												1,100
												1,200
												1,300
												1,400
												1,500

Car depth

Clear door opening

Note: Car width and depth variable in increments of 5 mm.

For simplification, table samples show increments of 100 mm.

(1) HCM - minimum 2,000 mm